

# NC-kopplingar

## PRODUKTDATA

Arbetstemperatur: -20°C till +120°C,  
tillfälligt upp till  
150°C

Max arbetstryck:

**KOPPARRÖR:**  
20 bar vid 25°C  
10 bar vid 90°C

**PEX-RÖR:**  
12 bar vid 25°C  
5 bar vid 90°C

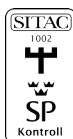

Kopplingar för hårda, halvhårda och mjuka kopparrör samt för PEX-rör (med stödhylsa).

Kopplingarna kan användas i alla vattenburna system och kan ses som ett alternativ till klämrings-, press- eller lödkopplingar.

Anslutningen sker utan verktyg genom att röret skjuts in i kopplingen och därmed är installationen klar.

Tidsbesparing jämfört med presskopplingar är 45%, klämringskopplingar 70% och lödkopplingar 90%.

Sortimentet omfattar de vanligaste typerna av rörkopplingar och finns för rör från 12 mm till 28 mm.

Alla kopplingar är tillverkade i avzinkningshärdig mässing.



## 610 RAK KOPPLING MED INVÄNDIG GÄNGA

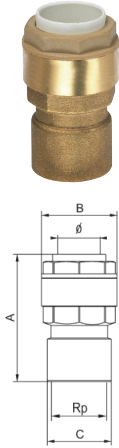

| Art.nr    | ØxRp    | A (mm) | B (mm) | C (mm) | Ant/fp | RSK     |
|-----------|---------|--------|--------|--------|--------|---------|
| TI6101210 | 12x3/8" | 51,0   | 23,0   | 20,5   | 18/540 | 1854047 |
| TI6101215 | 12x1/2" | 54,5   | 23,0   | 24,0   | 14/420 | 1854141 |
| TI6101415 | 14x1/2" | 54,5   | 25,0   | 24,0   | 14/420 |         |
| TI6101515 | 15x1/2" | 54,5   | 26,0   | 24,0   | 14/420 | 1854142 |
| TI6101615 | 16x1/2" | 54,5   | 27,0   | 24,0   | 14/420 | 1854048 |
| TI6101815 | 18x1/2" | 58,4   | 31,5   | 24,0   | 7/210  |         |
| TI6101820 | 18x3/4" | 58,9   | 31,5   | 30,5   | 7/210  |         |
| TI6102015 | 20x1/2" | 60,7   | 34,0   | 24,5   | 10/210 |         |
| TI6102022 | 22x3/4" | 60,9   | 36,0   | 30,5   | 5/150  | 1854208 |
| TI6102520 | 25x3/4" | 63,0   | 40,0   | 30,5   | 8/168  |         |
| TI6102528 | 28x1"   | 69,5   | 43,7   | 37,5   | 5/150  | 1854143 |

## 615 RAK KOPPLING MED UTVÄNDIG GÄNGA

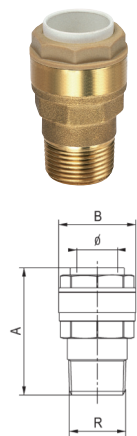

| Art.nr    | ØxR     | A (mm) | B (mm) | Ant/fp | RSK     |
|-----------|---------|--------|--------|--------|---------|
| TI6151210 | 12x3/8" | 40,0   | 23,0   | 24/720 | 1854049 |
| TI6151215 | 12x1/2" | 43,5   | 23,7   | 18/540 | 1854144 |
| TI6151410 | 14x3/8" | 48,8   | 25,0   | 18/540 |         |
| TI6151515 | 14x1/2" | 44,8   | 25,0   | 18/540 | 1854145 |
| TI6151615 | 15x1/2" | 44,8   | 26,0   | 18/540 | 1854146 |
| TI6151615 | 16x1/2" | 44,9   | 27,0   | 15/450 |         |
| TI6151815 | 18x1/2" | 54,9   | 31,5   | 15/225 |         |
| TI6151820 | 18x3/4" | 48,7   | 31,5   | 15/225 |         |
| TI6152015 | 20x1/2" | 58,5   | 34,0   | 14/224 |         |
| TI6152220 | 22x3/4" | 59,4   | 36,0   | 12/180 | 1854147 |
| TI6152520 | 25x3/4" | 62,0   | 40,0   | 11/176 |         |
| TI6152825 | 28x1"   | 65,8   | 43,7   | 8/104  | 1854149 |

## 620 RAK SKARVKOPPLING

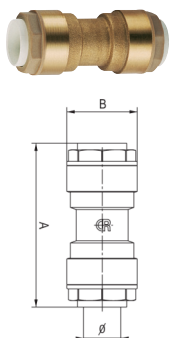

| Art.nr    | Ø     | A (mm) | B (mm) | Ant/fp | RSK     |
|-----------|-------|--------|--------|--------|---------|
| TI6201212 | 12x12 | 72,0   | 23,0   | 12/360 | 1854150 |
| TI6201414 | 14x14 | 72,0   | 25,0   | 12/360 |         |
| TI6201515 | 15x15 | 72,0   | 26,0   | 12/360 | 1854151 |
| TI6201616 | 16x16 | 72,0   | 27,0   | 12/360 | 1854152 |
| TI6201818 | 18x18 | 79,8   | 31,5   | 12/180 |         |
| TI6202020 | 20x20 | 85,0   | 34,0   | 10/130 |         |
| TI6202222 | 22x22 | 83,8   | 36,0   | 8/120  | 1854153 |
| TI6202525 | 25x25 | 88,0   | 40,0   | 7/112  |         |
| TI6202828 | 28x28 | 91,0   | 43,7   | 6/78   | 1854154 |



## 625 PROVTRYCKNINGSPROPP

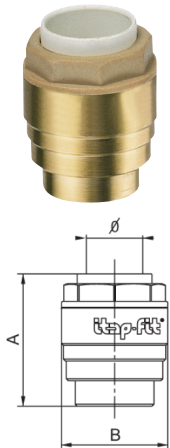

| Art.nr    | Ø  | A (mm) | B (mm) | Ant/fp | RSK     |
|-----------|----|--------|--------|--------|---------|
| Tl6250012 | 12 | 36,0   | 23,0   | 30/900 | 1854133 |
| Tl6250014 | 14 | 36,0   | 25,0   | 25/750 |         |
| Tl6250015 | 15 | 36,0   | 26,0   | 25/750 | 1854134 |
| Tl6250016 | 16 | 36,0   | 27,0   | 25/750 | 1854055 |
| Tl6250018 | 18 | 43,0   | 31,5   | 16/480 |         |
| Tl6250020 | 20 | 43,0   | 34,0   | 14/294 | 1854065 |
| Tl6250022 | 22 | 43,0   | 36,0   | 8/240  | 1854135 |

## 630 T-RÖRSKOPPLING

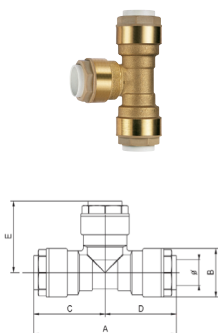

| Art.nr      | Ø        | A (mm) | B (mm) | C (mm) | D (mm) | E (mm) | Ant/fp | RSK     |
|-------------|----------|--------|--------|--------|--------|--------|--------|---------|
| Tl630121212 | 12x12x12 | 84,0   | 23,0   | 42,0   | 42,0   | 42,0   | 8/240  | 1854166 |
| Tl630141414 | 14x14x14 | 86,0   | 25,0   | 43,0   | 43,0   | 43,0   | 6/180  |         |
| Tl630151515 | 15x15x15 | 86,8   | 26,0   | 43,4   | 43,4   | 43,4   | 6/180  | 1854167 |
| Tl630161616 | 16x16x16 | 88,0   | 27,0   | 44,0   | 44,0   | 44,0   | 6/126  | 1854044 |
| Tl630181818 | 18x18x18 | 97,8   | 31,5   | 48,9   | 48,9   | 48,9   | 6/126  |         |
| Tl630202020 | 20x20x20 | 106,8  | 34,0   | 53,4   | 53,4   | 53,4   | 5/95   |         |
| Tl630222222 | 22x22x22 | 105,8  | 36,0   | 52,9   | 52,9   | 52,9   | 5/85   | 1854168 |
| Tl630252525 | 25x25x25 | 115,4  | 40,0   | 57,7   | 57,7   | 57,7   | 5/65   |         |
| Tl630282828 | 28x28x28 | 119,0  | 43,7   | 59,5   | 59,5   | 59,5   | 4/72   | 1854209 |

## 635 T-RÖRSKOPPLING

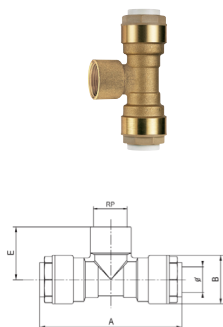

| Art.nr      | ØxRp       | A (mm) | B (mm) | E (mm) | Ant/fp | RSK     |
|-------------|------------|--------|--------|--------|--------|---------|
| Tl635121012 | 12x3/8"x12 | 84,0   | 23,0   | 28,0   | 8/240  | 1854045 |
| Tl635121512 | 12x1/2"x12 | 84,0   | 23,0   | 32,0   | 6/180  | 1854169 |
| Tl635141514 | 14x1/2"x14 | 86,0   | 25,0   | 32,5   | 6/180  |         |
| Tl635151515 | 15x1/2"x15 | 86,8   | 26,0   | 33,0   | 6/180  | 1854170 |
| Tl635161516 | 16x1/2"x16 | 88,0   | 27,0   | 33,5   | 6/180  | 1854046 |
| Tl635181518 | 18x1/2"x18 | 97,8   | 31,5   | 34,5   | 6/126  |         |
| Tl635182018 | 18x3/4"x18 | 97,8   | 31,5   | 37,3   | 6/126  |         |
| Tl635201520 | 20x1/2"x20 | 106,87 | 34,0   | 35,5   | 8/152  |         |
| Tl635222022 | 22x3/4"x22 | 105,8  | 36,0   | 40,0   | 6/96   | 1854210 |
| Tl635252025 | 25x3/4"x25 | 115,4  | 40,0   | 41,0   | 6/108  |         |
| Tl635282528 | 28x1"x28   | 119,0  | 43,7   | 47,2   | 4/72   | 1854211 |



## 640 VINKELKOPPLING MED UTVÄNDIG GÄNGA

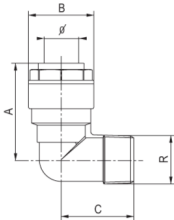

| Art.nr    | ØxR     | A (mm) | B (mm) | C (mm) | Ant/fp | RSK     |
|-----------|---------|--------|--------|--------|--------|---------|
| Ti6401210 | 12x3/8" | 42,0   | 23,0   | 28,0   | 12/360 | 1854051 |
| Ti6401215 | 12x1/2" | 42,0   | 23,0   | 32,0   | 12/360 | 1854174 |
| Ti6401415 | 14x1/2" | 43,0   | 25,0   | 32,5   | 12/360 |         |
| Ti6401515 | 15x1/2" | 43,4   | 26,0   | 33,0   | 12/360 | 1854175 |
| Ti6401615 | 16x1/2" | 44,0   | 27,0   | 33,5   | 10/300 | 1854052 |
| Ti6401815 | 18x1/2" | 48,9   | 31,5   | 34,5   | 10/210 |         |
| Ti6401820 | 18x3/4" | 48,9   | 31,5   | 37,3   | 10/210 |         |
| Ti6402015 | 20x1/2" | 53,4   | 34,0   | 35,5   | 10/240 |         |
| Ti6402022 | 22x3/4" | 52,9   | 36,0   | 40,0   | 8/168  | 1854176 |
| Ti6402520 | 25x3/4" | 57,7   | 40,0   | 41,0   | 8/192  |         |
| Ti6402528 | 28x1"   | 59,5   | 43,7   | 45,9   | 6/102  | 1854177 |

## 645 VINKELKOPPLING MED INVÄNDIG GÄNGA

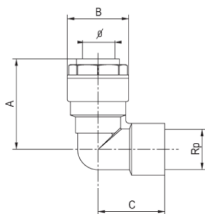

| Art.nr    | ØxRp    | A (mm) | B (mm) | C (mm) | Ant/fp | RSK     |
|-----------|---------|--------|--------|--------|--------|---------|
| Ti6451210 | 12x3/8" | 42,0   | 23,0   | 28,5   | 12/360 | 1854053 |
| Ti6451215 | 12x1/2" | 42,0   | 23,0   | 32,0   | 12/360 | 1854178 |
| Ti6451415 | 14x1/2" | 43,0   | 25,0   | 32,6   | 12/360 |         |
| Ti6451515 | 15x1/2" | 43,4   | 26,0   | 33,0   | 12/360 | 1854179 |
| Ti6451615 | 16x1/2" | 44,0   | 27,0   | 33,5   | 10/300 | 1854054 |
| Ti6451815 | 18x1/2" | 48,9   | 31,5   | 34,5   | 10/210 |         |
| Ti6451820 | 18x3/4" | 48,9   | 31,5   | 37,3   | 10/210 |         |
| Ti6452015 | 20x1/2" | 53,4   | 34,0   | 35,5   | 10/240 |         |
| Ti6452022 | 22x3/4" | 52,9   | 36,0   | 40,0   | 8/168  | 1854180 |
| Ti6452520 | 25x3/4" | 57,7   | 40,0   | 41,1   | 8/192  |         |
| Ti6452528 | 28x1"   | 59,5   | 43,7   | 47,2   | 6/102  | 1854181 |

## 648 VENTILFÄSTE

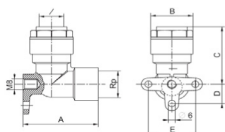

| Art.nr    | ØxRp    | A (mm) | B (mm) | C (mm) | D (mm) | E (mm) | Ant/fp | RSK     |
|-----------|---------|--------|--------|--------|--------|--------|--------|---------|
| Ti6481210 | 12x3/8" | 47,0   | 23,0   | 42,0   | 16,0   | 35,0   | 6/180  |         |
| Ti6451215 | 12x1/2" | 50,5   | 23,0   | 42,0   | 16,0   | 35,0   | 6/126  |         |
| Ti6481415 | 14x1/2" | 52,1   | 25,0   | 42,9   | 16,0   | 35,0   | 6/126  |         |
| Ti6481515 | 15x1/2" | 53,0   | 26,0   | 43,4   | 16,0   | 35,0   | 6/126  | 1854058 |
| Ti6481615 | 16x1/2" | 54,0   | 27,0   | 44,0   | 16,0   | 35,0   | 6/126  |         |
| Ti6481815 | 18x1/2" | 57,3   | 31,5   | 48,9   | 18,0   | 40,0   | 6/102  |         |
| Ti6481820 | 18x3/4" | 60,1   | 31,5   | 48,9   | 18,0   | 40,0   | 6/102  |         |
| Ti6482015 | 20x1/2" | 59,3   | 34,0   | 53,4   | 18,0   | 40,0   | 6/96   |         |
| Ti6482220 | 22x3/4" | 65,0   | 36,0   | 52,9   | 18,0   | 40,0   | 6/102  |         |



## 650 VINKELKOPPLING

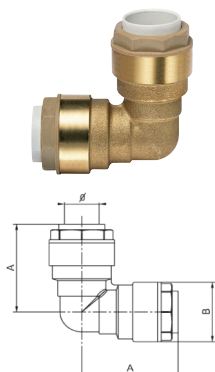

| Art.nr    | Ø     | A (mm) | B (mm) | Ant/fp | RSK     |
|-----------|-------|--------|--------|--------|---------|
| TI6501212 | 12x12 | 42,0   | 23,0   | 12/360 | 1854182 |
| TI6501414 | 14x14 | 43,0   | 25,0   | 10/300 |         |
| TI6501515 | 15x15 | 43,4   | 26,0   | 10/300 | 1854183 |
| TI6501616 | 16x16 | 44,0   | 27,0   | 10/210 | 1854184 |
| TI6501818 | 18x18 | 48,9   | 31,5   | 10/210 |         |
| TI6502020 | 20x20 | 53,4   | 34,0   | 8/152  |         |
| TI6502222 | 22x22 | 52,9   | 36,0   | 8/136  | 1854185 |
| TI6502525 | 25x25 | 57,7   | 40,0   | 6/114  |         |
| TI6502828 | 28x28 | 59,5   | 43,7   | 5/85   | 1854186 |

## 655 STÖDHYLSA

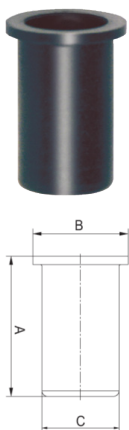

| Art.nr      | Ø                        | A (mm) | B (mm) | C (mm) | Ant/fp | RSK     |
|-------------|--------------------------|--------|--------|--------|--------|---------|
| TI655012110 | 12x1,1 / 14x2            | 20,0   | 12,0   | 9,5    | 50     | 1854061 |
| TI655012160 | 12x1,6                   | 20,0   | 11,5   | 8,6    | 50     | 1854062 |
| TI655012180 | 12x1,8                   | 20,0   | 11,5   | 8,2    | 50     | 1854190 |
| TI655012200 | 12x2                     | 20,0   | 11,5   | 7,8    | 50     | 1854191 |
| TI655015250 | 15x1,8 / 16x2,2 / 16x2,3 | 20,0   | 14,5   | 11,3   | 50     | 1854063 |
| TI655015180 | 15x2,5                   | 20,0   | 14,0   | 9,5    | 50     | 1854193 |
| TI655016150 | 16x1,5 / 17x2 / 18x2,5   | 25,0   | 16,0   | 12,8   | 50     |         |
| TI655016180 | 16x1,8 / 17x2,3          | 20,0   | 15,0   | 12,2   | 50     |         |
| TI655016200 | 16x2                     | 20,0   | 15,0   | 11,8   | 50     |         |
| TI655018200 | 18x2                     | 25,0   | 17,0   | 13,7   | 50     |         |
| TI655020190 | 20x1,9 / 20x2 / 22x3     | 25,0   | 18,0   | 15,6   | 40     | 1854194 |
| TI655020280 | 20x2,8                   | 25,0   | 18,0   | 14,2   | 40     |         |
| TI655022200 | 22x2 / 22x2,1 / 25x3,5   | 29,0   | 21,0   | 17,5   | 40     |         |
| TI655025230 | 25x2,3                   | 29,0   | 22,5   | 20,0   | 40     |         |
| TI655025250 | 25x2,5                   | 29,0   | 22,5   | 19,6   | 40     | 1854195 |
| TI655028300 | 28x3                     | 29,0   | 26,5   | 21,6   | 40     |         |
| TI65528280  | 28x2,8                   | 29,0   | 26,5   | 22,2   | 40     |         |

När NC-kopplingen ansluts till PEX-rör skall stödhylsan användas. Kod = utv. diameter x tjocklek på rörväggen.

## 685 MÅTT RÖRDJUP



| Art.nr    | Benämning        | Ø     | RSK     |
|-----------|------------------|-------|---------|
| TI6850000 | 685 Mått rördjup | 12÷28 | 1854064 |

Används för att se till att röret bottenar i kopplingen.

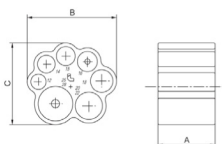



## 672 DEMONTERINGSVERKTYG



| Art.nr    | Ø              | Ant/fp | RSK |
|-----------|----------------|--------|-----|
| TI6721228 | 12, 15, 22, 28 | 1      |     |
| TI6721625 | 16, 20, 25     | 1      |     |

## 660 REDUCERING



| Art.nr      | Ø     | Ant/fp | RSK     |
|-------------|-------|--------|---------|
| TI660015-12 | 15-12 | 15     | 1854224 |
| TI660016-12 | 16-16 | 15     |         |
| TI660018-14 | 18-14 | 12     |         |
| TI660018-15 | 18-15 | 12     | 1854227 |
| TI660020-14 | 20-14 | 10     |         |
| TI660020-15 | 20-15 | 10     |         |
| TI660020-16 | 20-16 | 10     |         |
| TI660022-15 | 22-15 | 10     | 1854231 |
| TI660022-16 | 22-16 | 10     |         |
| TI660022-18 | 22-18 | 10     | 1854233 |
| TI660025-16 | 25-16 | 10     |         |
| TI660025-20 | 25-20 | 10     |         |
| TI660028-15 | 28-15 | 6      | 1854236 |
| TI660028-18 | 28-18 | 6      | 1854237 |
| TI660028-22 | 28-22 | 6      | 1854238 |